

FLOOR PLAN

SCALE: NTS

ARCH REF: A1/A100
A1/A111

QUANTITY: TYPE A - 01
TYPE B - 01
TYPE C - 01
TYPE D - 06
TYPE A1 - 01

LBL

GROUND LEVEL

GLASS WALL SYSTEM(S):

KAWNEER IR 501 IMPACT RESISTANT ALUMINUM STOREFRONT
 KAWNEER 350 IR IMPACT RESISTANT MEDIUM STILE ENTRANCE DOORS
 ASSA ABLOY SL500 RESILIENCE IMPACT RESISTANT SLIDING DOORS
 ASSA ABLOY SL500 BESAM INTERIOR SLIDING DOORS

TYPE E - 01 TYPE F - 01 TYPE G - 01 TYPE H - 01 TYPE J - 01
 TYPE B1 - 01

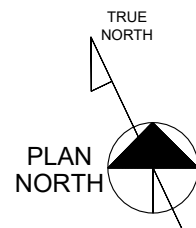

NO.	DATE	BY	DESCRIPTION
1	10/01/21	fp	Corrections to First Submittal
1	04/06/21	fp	First Submittal

EVINS GLASS SERVICE, INC.
 101 N.P.I.D., CORPUS CHRISTI, TX 78406
 WORK (361) 884-3995 FAX (361) 884-4262

PROJECT: CoastLife, PORTLAND BRANCH
NEW BUILDING
 ARCHITECT: MG ARCHITECTS
 713-582-9707
 GENERAL CONTRACTOR: INTEGRATED BUILDERS GROUP
 816-268-4737

PROJECT NO.	EGS-2103-02
DRAWN BY	fp
DATE	10/01/2021
SCALE	NTS
DRAWING	FLOOR PLANS
SHEET	P1

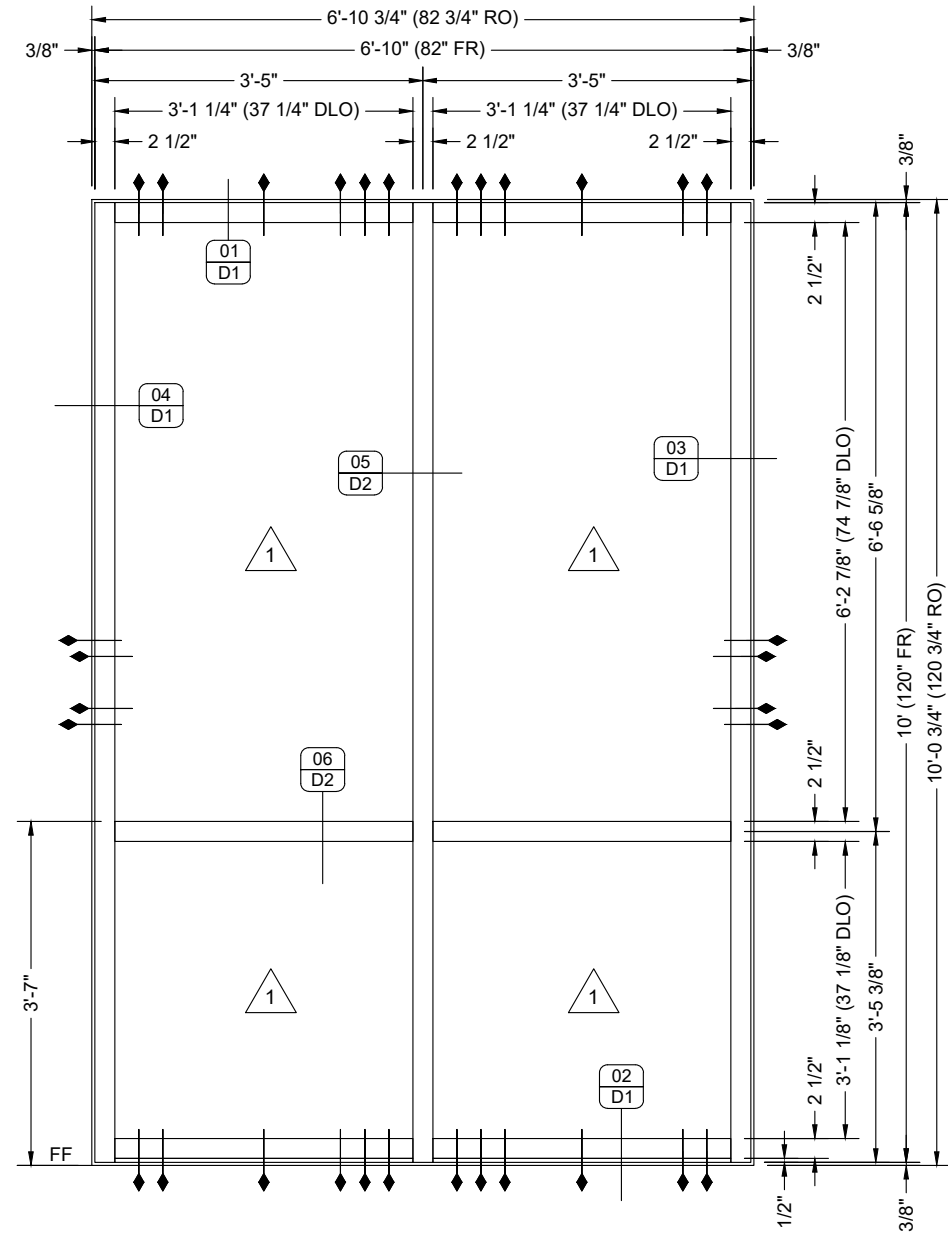

NOTE: SEE ANCHORING DRAWINGS FOR ANCHOR TYPES AND SPACING.

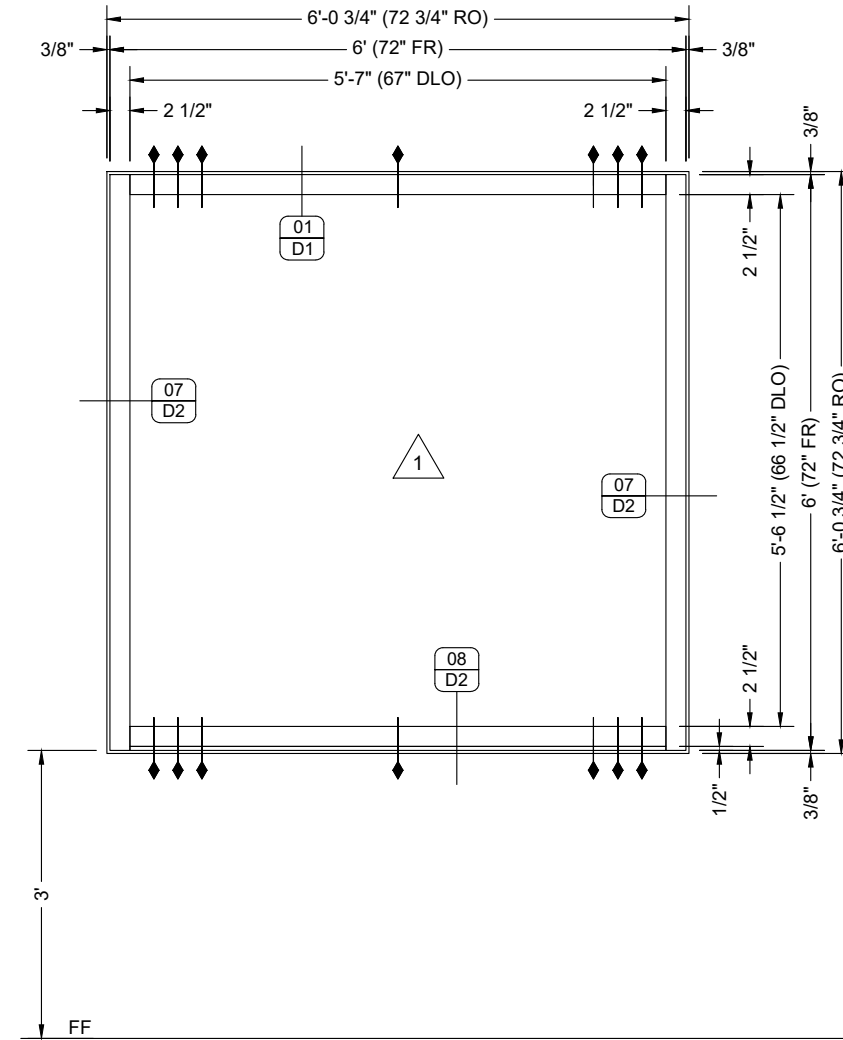

ELEVATION

QUANTITY: 01
 SCALE: 1/2" = 1'-0"
 ARCH REF: A1/A111
 B1/A201
 B6/A501
 C6/A501
 A3/A603

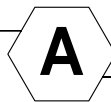

EXT STOREFRONT

KAWNEER IR 501 IMPACT ALUMINUM STOREFRONT

ELEVATION

QUANTITY: 01
 SCALE: 1/2" = 1'-0"
 ARCH REF: A1/A111
 B1/A201
 A2/A311
 C1/A501
 B1/A501
 A3/A603

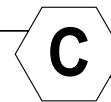

EXT STOREFRONT

KAWNEER IR 501 IMPACT ALUMINUM STOREFRONT

EVINS GLASS SERVICE, INC.

101 N.P.I.D., CORPUS CHRISTI, TX 78406
 WORK (361) 884-3995 FAX (361) 884-4262

PROJECT: CoastLife PORTLAND BRANCH
NEW BUILDING
 ARCHITECT: MG ARCHITECTS
 713-582-0707
 GENERAL CONTRACTOR: INTEGRATED BUILDERS GROUP
 816-268-4737

PROJECT NO.		EGS-2103-02
DRAWN BY	DATE	
fp	10/01/2021	
SCALE		1/2" = 1'-0"
DRAWING		ELEVATIONS
SHEET		E1

NO.	DATE	DESCRIPTION
1	10/01/21	fp
1	04/06/21	fp
		Submittal
		First Submittal
		Corrections to First Submittal

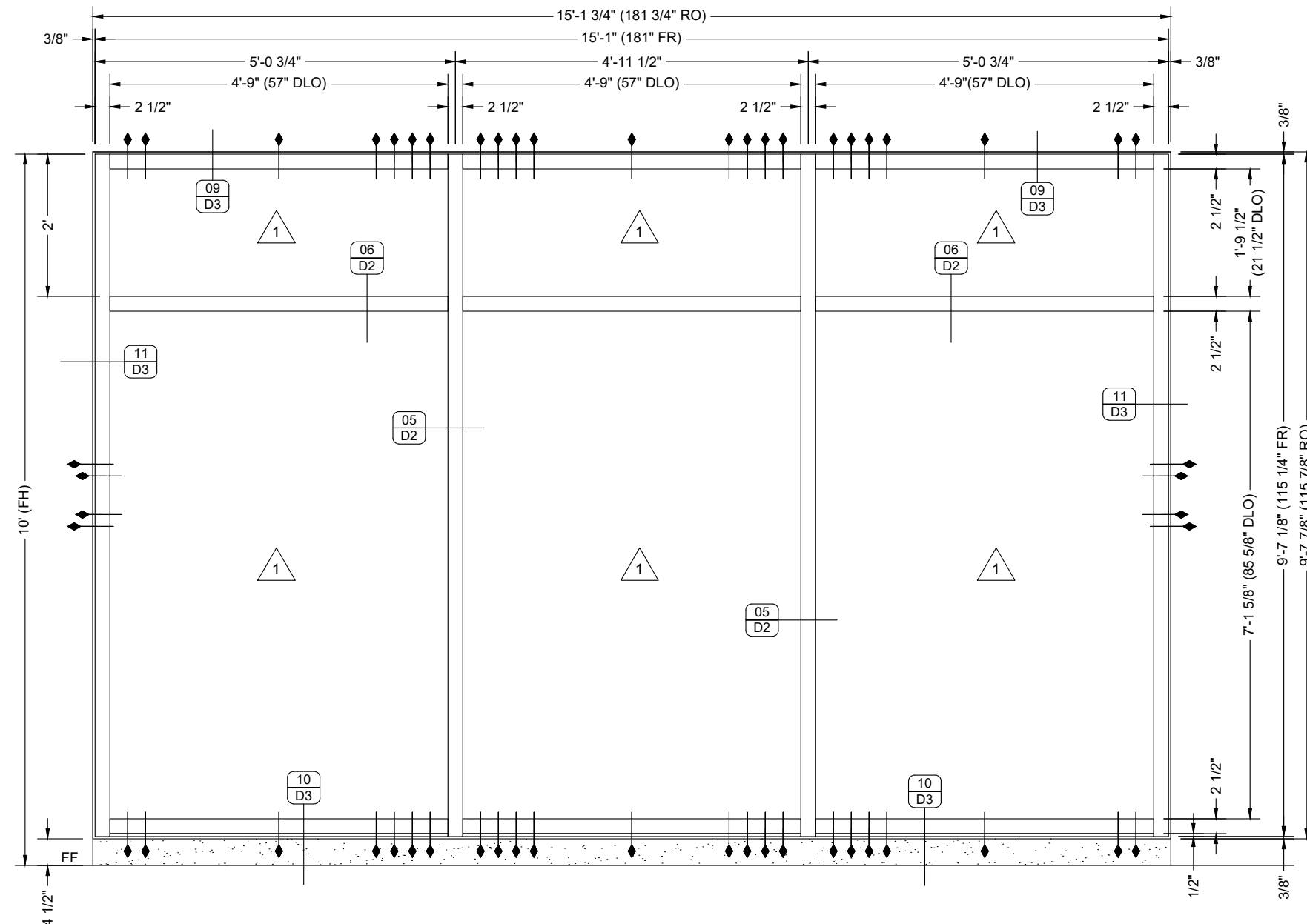

ELEVATION

QUANTITY: 01
 SCALE: 1/2" = 1'-0"
 ARCH REF: A1/A111
 B1/A201
 C1/A301
 A1/A311
 B4/A503
 A4/A503
 A3/A603

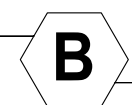

EXT STOREFRONT

KAWNEER IR 501 IMPACT ALUMINUM STOREFRONT

NOTE: SEE ANCHORING DRAWINGS FOR ANCHOR TYPES AND SPACING.

EVINS GLASS SERVICE, INC.
 101 N.P.I.D., CORPUS CHRISTI, TX 78406
 WORK (361) 884-3995 FAX (361) 884-4262

PROJECT: CoastLife, PORTLAND BRANCH
NEW BUILDING
 ARCHITECT: MG ARCHITECTS
 713-582-0707
 GENERAL CONTRACTOR: INTEGRATED BUILDERS GROUP
 816-268-4737

PROJECT NO.		EGS-2103-02
DRAWN BY	DATE	
fp	10/01/2021	
SCALE		1/2" = 1'-0"
DRAWING		ELEVATIONS
SHEET		E2

SUB	BY	DATE	DESCRIPTION
1	fp	10/01/21	Corrections to First Submittal
1	fp	04/06/21	First Submittal

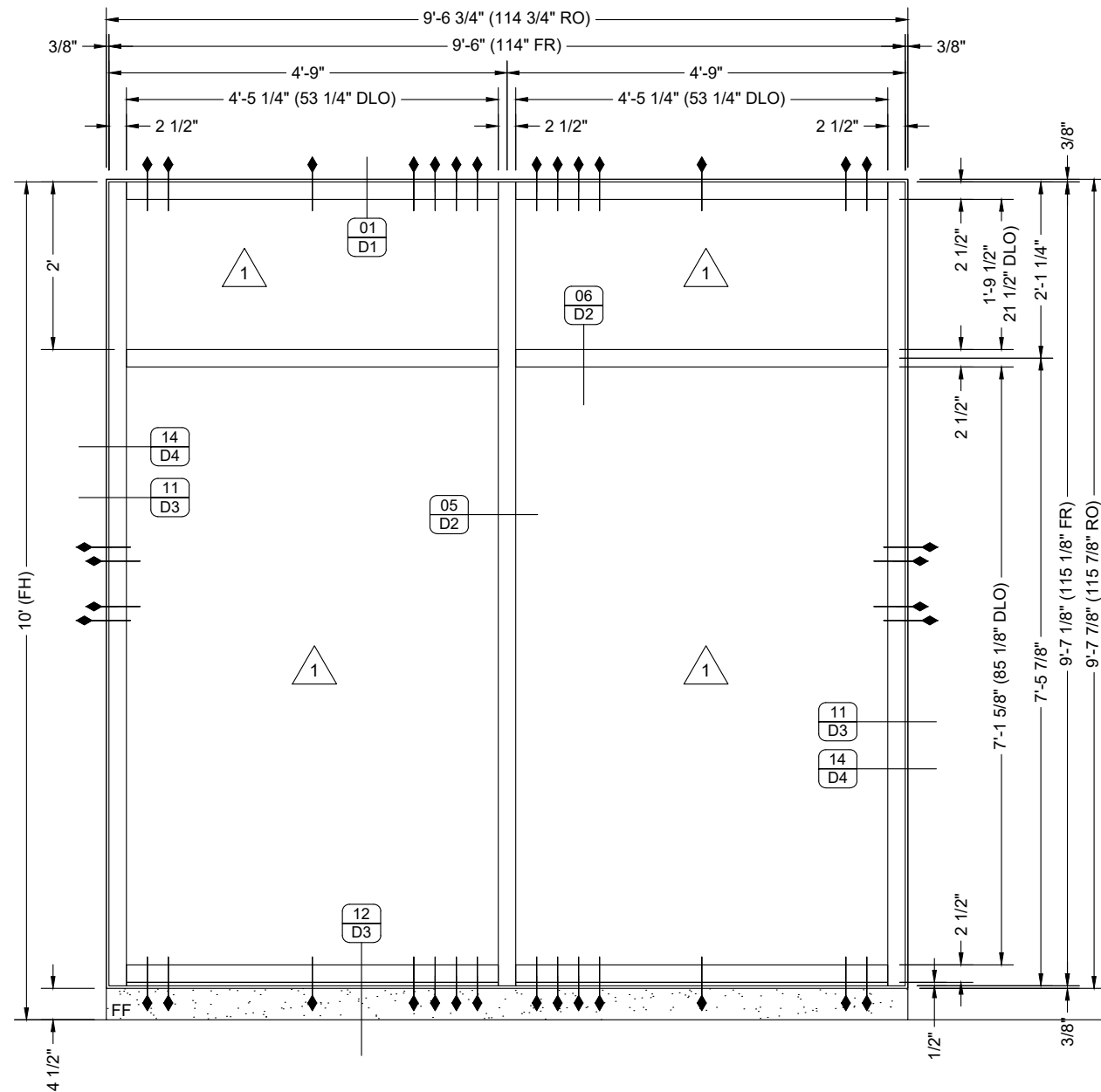

NOTE: SEE ANCHORING DRAWINGS FOR ANCHOR TYPES AND SPACING.

ELEVATION

QUANTITY: 06
 SCALE: 1/2" = 1'-0"
 ARCH REF: A1/A111
 A1/A201
 B4/A301
 B4/A311
 C1/A501
 A3/A603



EXT STOREFRONT

KAWNEER IR 501 IMPACT ALUMINUM STOREFRONT

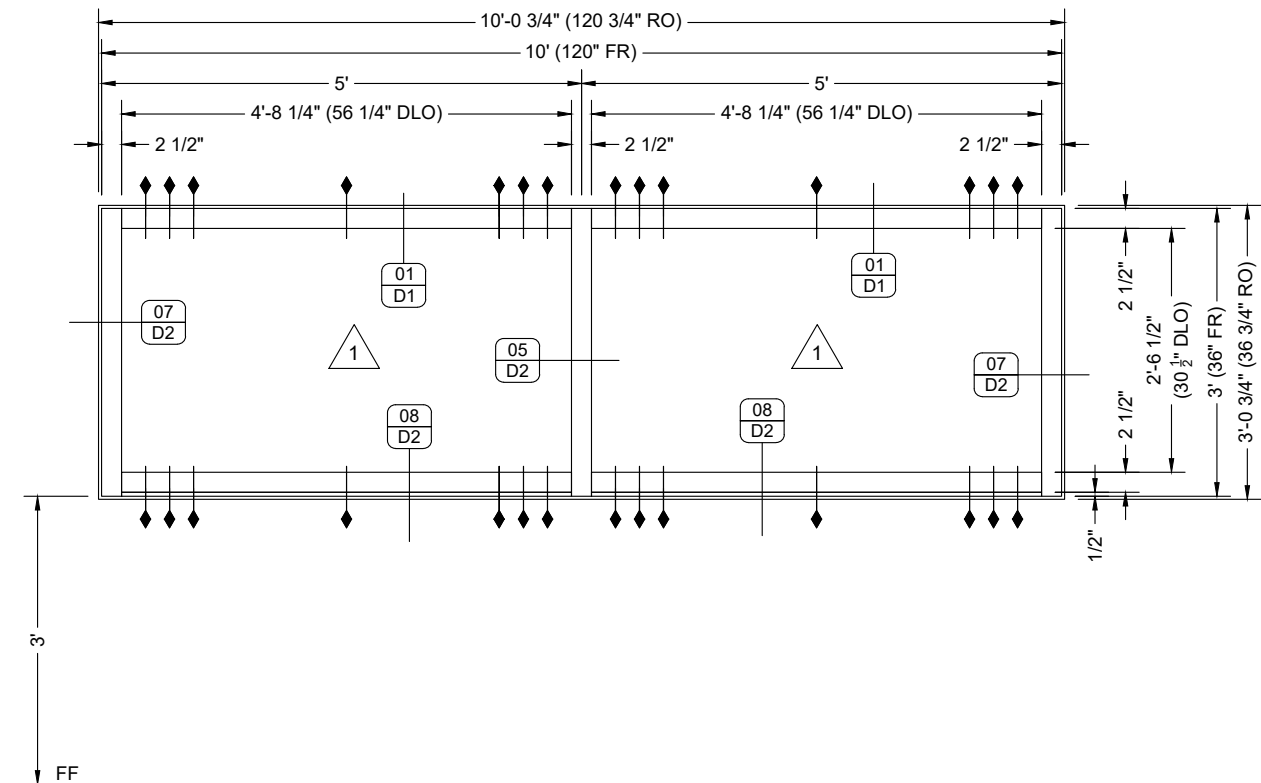

ELEVATION

QUANTITY: 06
 SCALE: 1/2" = 1'-0"
 ARCH REF: A1/A111
 D1/A201
 A3/A603

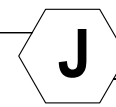

EXT STOREFRONT

KAWNEER IR 501 IMPACT ALUMINUM STOREFRONT

DATE	DESCRIPTION
10/01/21	Corrections to First Submittal
04/06/21	First Submittal

EVINS GLASS SERVICE, INC.
 101 N.P.I.D., CORPUS CHRISTI, TX 78406
 WORK (361) 884-3995 FAX (361) 884-4262

PROJECT: CoastLife PORTLAND BRANCH
NEW BUILDING
 ARCHITECT: MG ARCHITECTS
 713-582-0707
 GENERAL CONTRACTOR: INTEGRATED BUILDERS GROUP
 916-268-4737

PROJECT NO. EGS-2103-02	
DRAWN BY: fp	DATE: 10/01/2021
SCALE: 1/2" = 1'-0"	
DRAWING: ELEVATIONS	
SHEET: E3	

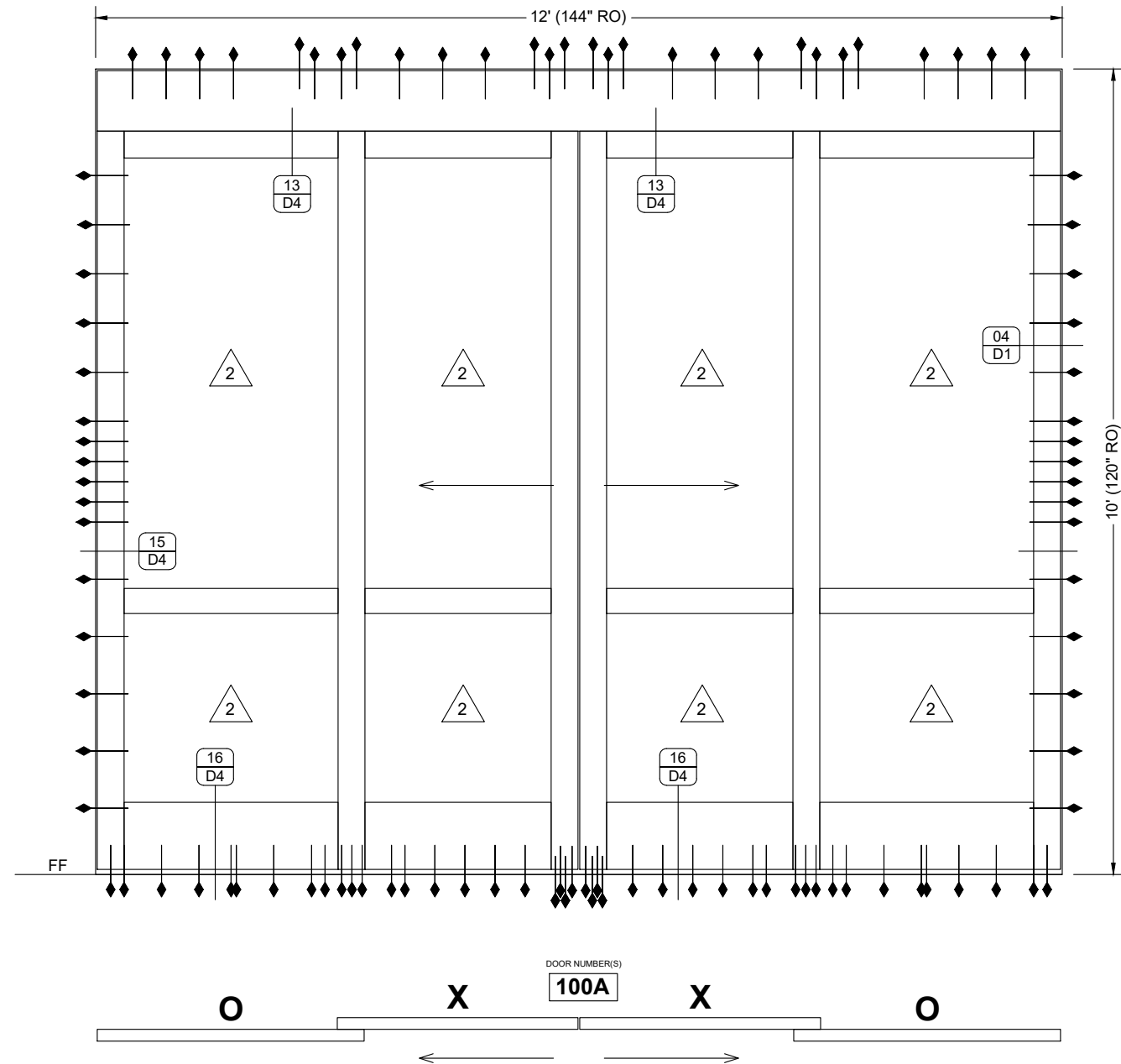

HARDWARE

DOOR(S): 100A (SLIDER)
 GROUP: SPECIFIC TO DOOR

NOTE: REFER TO DOOR MANUFACTURER SUBMITTALS IN THE REFERENCE SHEETS FOR THE DIMENSIONS, INSTALLATION INSTRUCTIONS AND ANY HARDWARE ASSOCIATED WITH THE DOOR.

NOTE: VERIFY WINDSTORM CERTIFICATION OF SPECIFIED HARDWARE BUILT AS BASIS-OF-DESIGN ACCORDING TO THE APPROVED PRODUCT EVALUATION DOCUMENTS FOR DOOR MANUFACTURER.

ELEVATION

QUANTITY: 01
 SCALE: 1/2" = 1'-0"
 ARCH REF: A1/A111
 A1/A201
 A1/A312
 A2/A501
 B2/A501
 A3/A603



EXT SLIDING DOOR

ASSA ABLOY SL500 RESILIENCE IMPACT SLIDING DOOR SYSTEM

DATE	DESCRIPTION
10/01/21	10/01/21
fp	fp
1	1
SUB	SUB

EVINS GLASS SERVICE, INC.
 101 N.P.I.D., CORPUS CHRISTI, TX 78406
 WORK (361) 884-3995 FAX (361) 884-4262

PROJECT: CoastLife, PORTLAND BRANCH
NEW BUILDING
 ARCHITECT: MG ARCHITECTS
 713-582-0707
 GENERAL CONTRACTOR: INTEGRATED BUILDERS GROUP
 816-268-4737

PROJECT NO. EGS-2103-02

DRAWN BY: fp DATE: 10/01/2021

SCALE: 1/2" = 1'-0"

DRAWING: ELEVATIONS

SHEET: E4

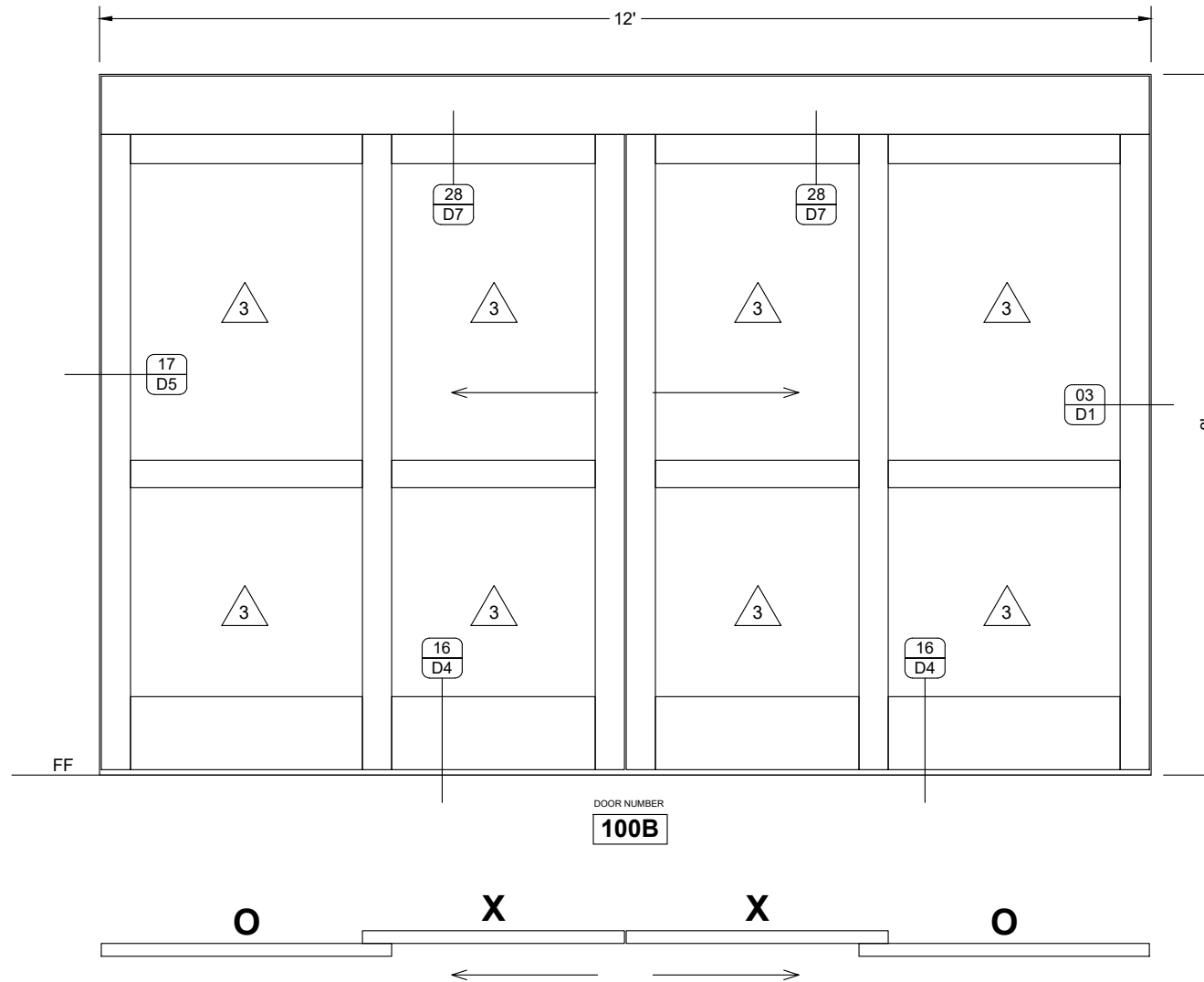

ELEVATION

QUANTITY: 01
 SCALE: 1/2" = 1'-0"
 ARCH REF: A1/A111
 C5/A501
 C6/A501
 A3/A603



INT SLIDING DOOR

ASSA ABLOY BESAM SL500 ALUMINUM SLIDING DOOR SYSTEM

HARDWARE

DOOR(S): 100B (SLIDER)
 GROUP: SPECIFIC TO DOOR

NOTE: REFER TO DOOR MANUFACTURER SUBMITTALS IN THE REFERENCE SHEETS FOR THE DIMENSIONS, INSTALLATION INSTRUCTIONS AND ANY HARDWARE ASSOCIATED WITH THE DOOR.

NO.	DATE	DESCRIPTION
1	10/01/21	Corrections to First Submittal
1	04/06/21	First Submittal

EVINS GLASS SERVICE, INC.
 101 N.P.I.D., CORPUS CHRISTI, TX 78406
 WORK (361) 884-3995 FAX (361) 884-4262

PROJECT: CoastLife, PORTLAND BRANCH
NEW BUILDING
 ARCHITECT: MG ARCHITECTS
 713-582-0707
 GENERAL CONTRACTOR: INTEGRATED BUILDERS GROUP
 816-268-4737

PROJECT NO. EGS-2103-02

DRAWN BY: fp DATE: 10/01/2021

SCALE: 1/2" = 1'-0"

DRAWING: ELEVATIONS

SHEET: E5

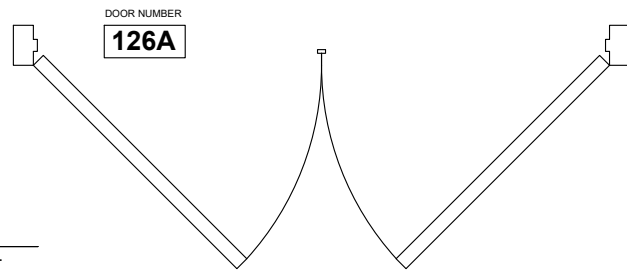
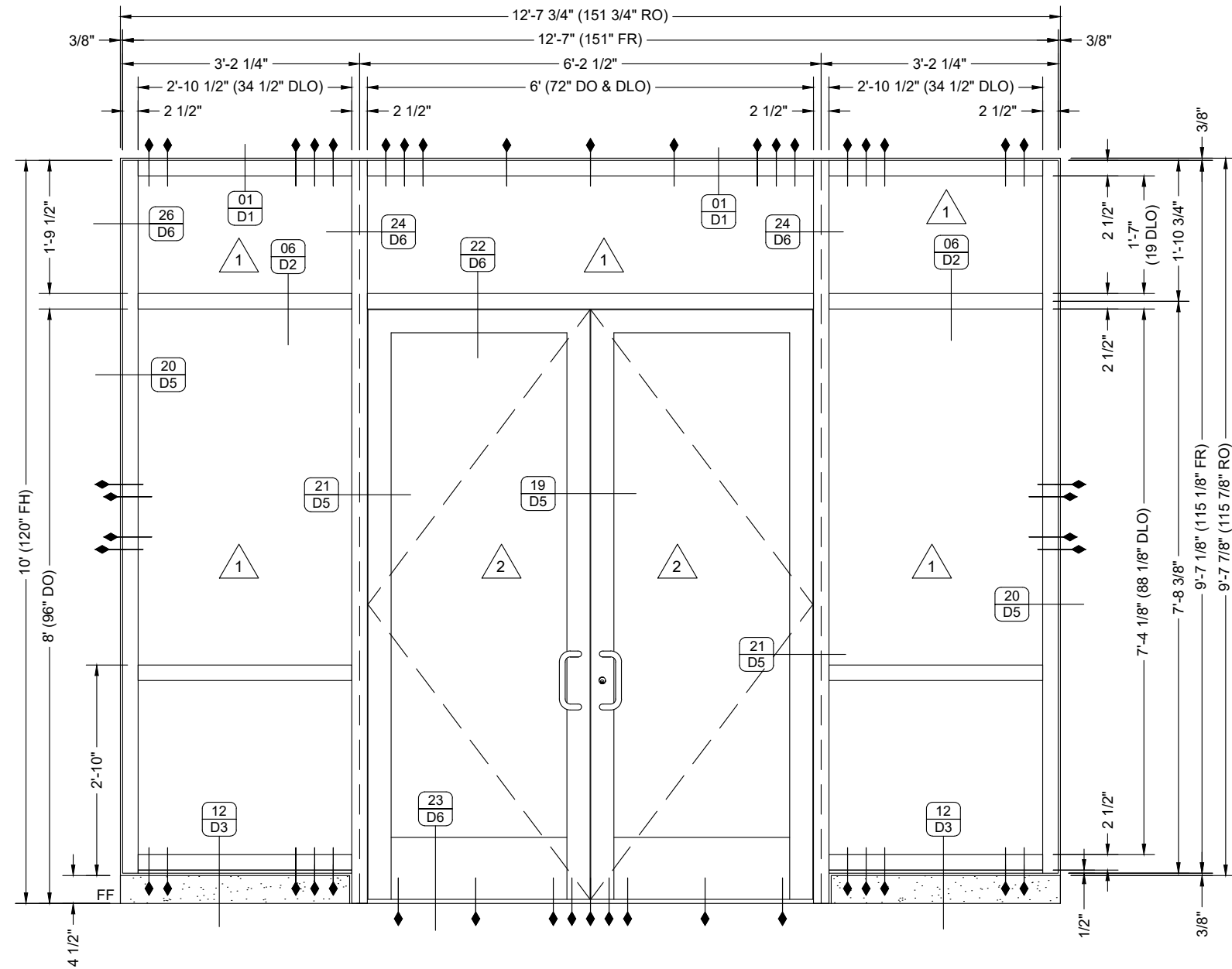

HARDWARE

DOOR(S): 126A (PAIR)
 GROUP #34W

- 2 Continuous Gear Hinge BY DOOR MANUFACTURER
- 1 Panic Hardware VON DUPRIN HH-9947-NL-EO-SNB LENGTH & HEIGHT AS REQUIRED
- 1 Panic Hardware VON DUPRIN HH-9947-OP-SNB LENGTH & HEIGHT AS REQUIRED
- 1 Rim Cylinder SCHLAGE 20-057
- 2 90 Degree Offset Pull IVES 8190-O 10"
- 2 Closures LCN-4041 XP PA SCUSH N STOP
- 1 Seal PERIMETER SEAL BY FRAME MANUFACTURER
- 1 Astragal MEETING STILE SEAL BY DOOR MANUFACTURER
- 2 Door Sweep ZERO APPROVED FOR USE WITH OPENING SYSTEM
- 1 Threshold ZERO APPROVED FOR USE WITH OPENING SYSTEM

NOTE: VERIFY WINDSTORM CERTIFICATION OF SPECIFIED HARDWARE BUILT AS BASIS-OF-DESIGN AROUND KAWNEER 500 IR DOOR SYSTEM.

ELEVATION

QUANTITY: 01
 SCALE: 1/2" = 1'-0"
 ARCH REF: A1/A111
 A6/A501
 A5/A603
 DOOR NUMBER(S): 126A



EXT STOREFRONT

KAWNEER IR 501 IMPACT ALUMINUM STOREFRONT

NOTE: SEE ANCHORING DRAWINGS FOR ANCHOR TYPES AND SPACING.

DATE	DESCRIPTION
10/01/21	Corrections to First Submittal
04/06/21	First Submittal

EVINS GLASS SERVICE, INC.
 101 N.P.I.D., CORPUS CHRISTI, TX 78406
 WORK (361) 884-3995 FAX (361) 884-4262

PROJECT: CoastLife PORTLAND BRANCH
NEW BUILDING
 ARCHITECT: MG ARCHITECTS
 713-562-0707
 GENERAL CONTRACTOR: INTEGRATED BUILDERS GROUP
 816-268-4737

PROJECT NO. EGS-2103-02	
DRAWN BY: fp	DATE: 10/01/2021
SCALE: 1/2" = 1'-0"	
DRAWING: ELEVATIONS	
SHEET: E6	

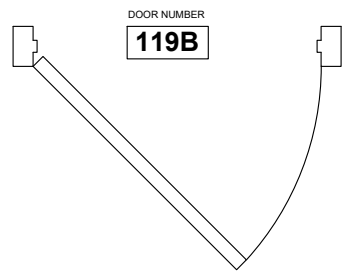
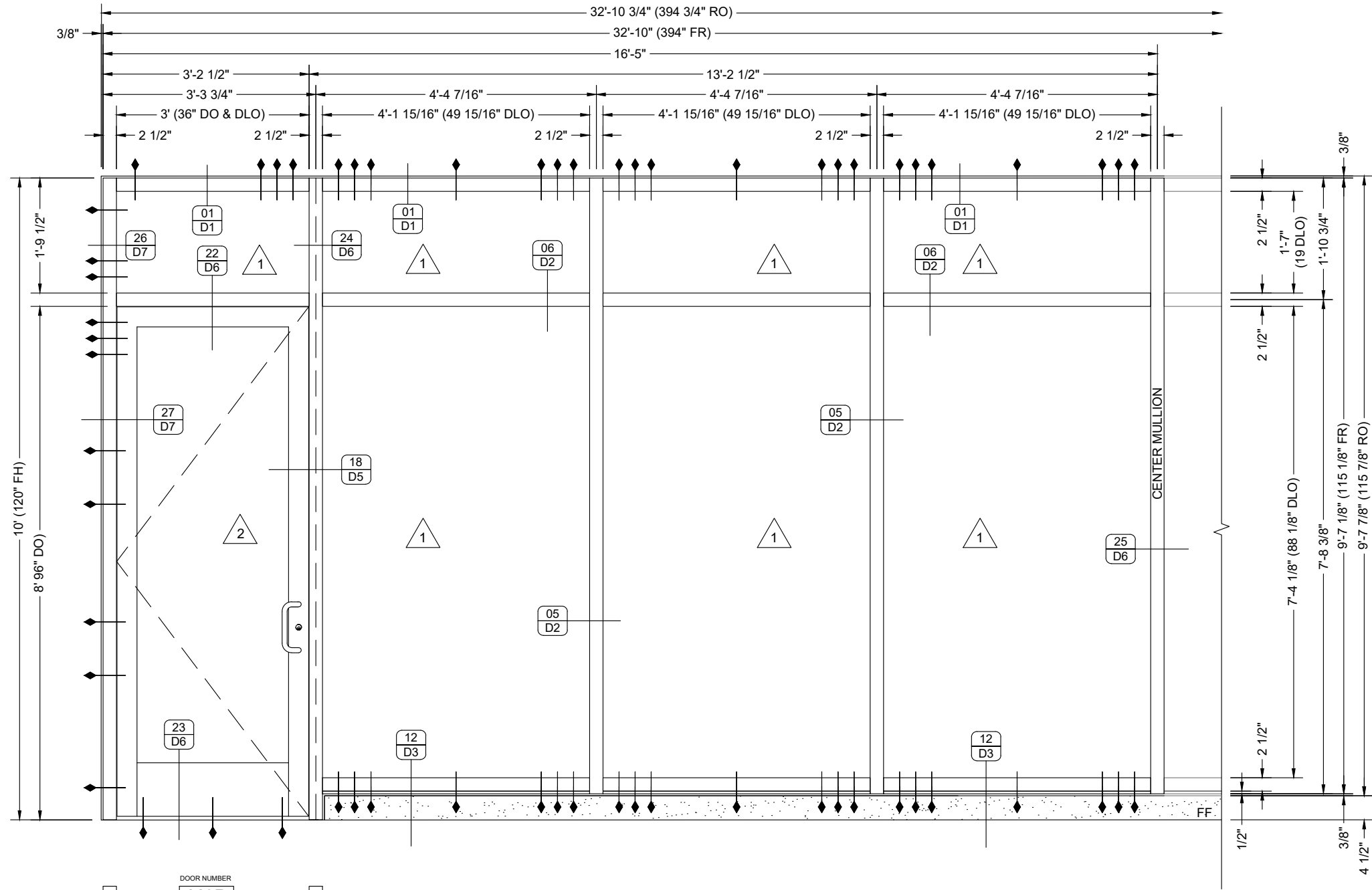

HARDWARE

DOOR(S): 119B (SINGLE)
 GROUP #36W

- 2 Continuous Gear Hinge BY DOOR MANUFACTURER
- 1 Panic Hardware VON DUPRIN HH-9947-NL-OP
- 1 Rim Cylinder SCHLAGE 20-057
- 2 90 Degree Offset Pull IVES 8190-O 10"
- 2 Closures LCN-4040 XP PA S CUSN N STOP
- 1 Seal PERIMETER SEAL BY FRAME MANUFACTURER
- 2 Door Sweep ZERO APPROVED FOR USE WITH OPENING SYSTEM
- 1 Threshold ZERO APPROVED FOR USE WITH OPENING SYSTEM

NOTE: SEE ANCHORING DRAWINGS FOR ANCHOR TYPES AND SPACING.

NOTE: VERIFY WINDSTORM CERTIFICATION OF SPECIFIED HARDWARE BUILT AS BASIS-OF-DESIGN AROUND KAWNEER 500 IR DOOR SYSTEM.

ELEVATION

QUANTITY: 01
 SCALE: 1/2" = 1'-0"
 ARCH REF: A1/A111
 A1/A201
 B1/A301
 A3/A312
 C1/A501
 DOOR NUMBER(S): 119B



EXT STOREFRONT [LEFT HALF]

KAWNEER IR 501 IMPACT ALUMINUM STOREFRONT

DATE	DESCRIPTION
10/01/21	Corrections to First Submittal
04/06/21	First Submittal

EVINS GLASS SERVICE, INC.
 101 N.P.I.D., CORPUS CHRISTI, TX 78406
 WORK (361) 884-3995 FAX (361) 884-4262

PROJECT: CoastLife PORTLAND BRANCH
NEW BUILDING
 ARCHITECT: MG ARCHITECTS
 713-582-0707
 GENERAL CONTRACTOR: INTEGRATED BUILDERS GROUP
 816-268-4737

PROJECT NO. EGS-2103-02	
DRAWN BY: fp	DATE: 10/01/2021
SCALE: 1/2" = 1'-0"	
DRAWING: ELEVATIONS	
SHEET: E7	

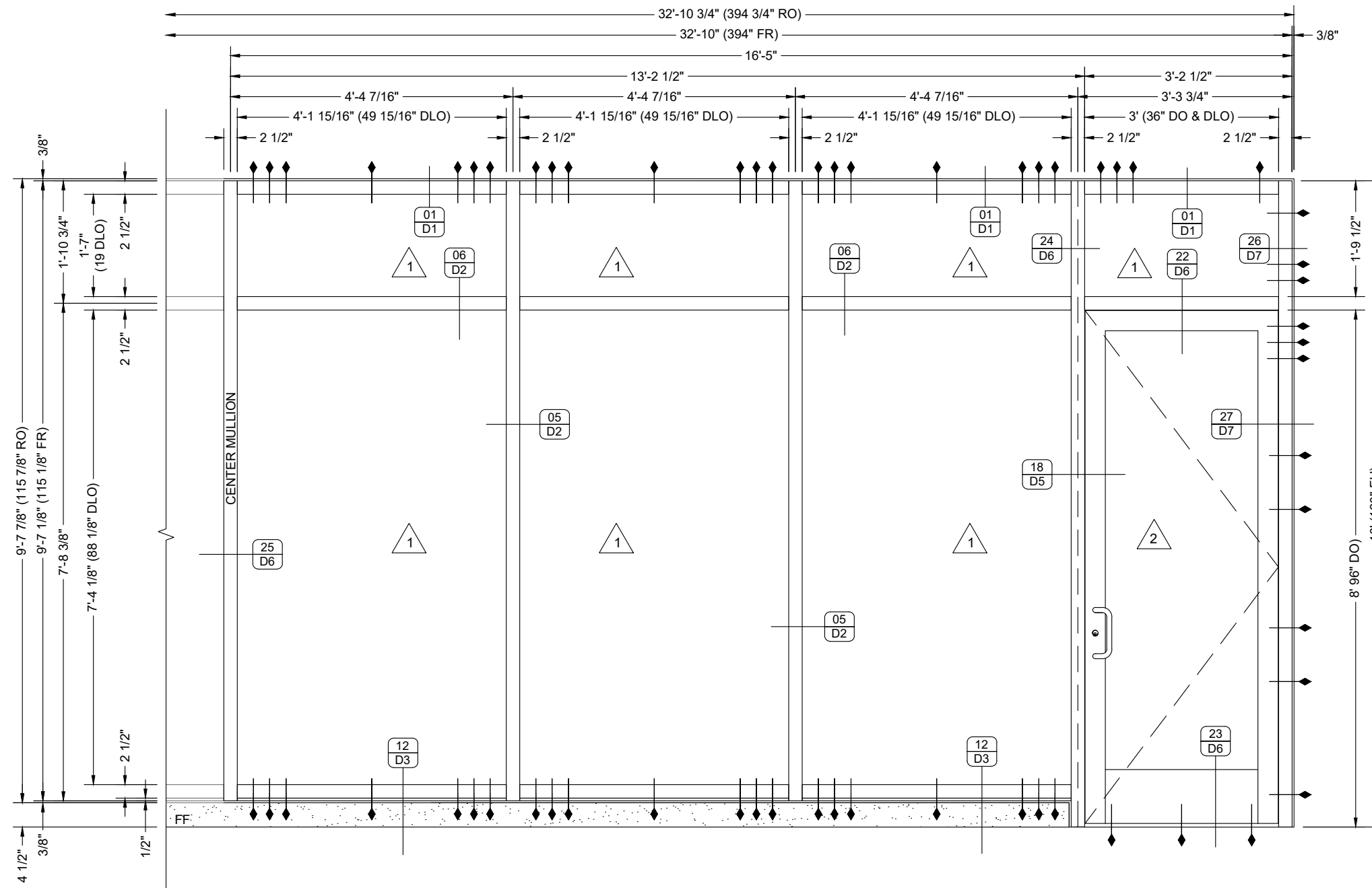

ELEVATION

QUANTITY: 01
SCALE: 1/2" = 1'-0"
ARCH REF: A1/A111
A1/A201
B1/A301
A3/A312
C1/A501
DOOR NUMBER(S): 119A

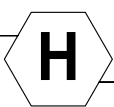

EXT STOREFRONT [RIGHT HALF]

KAWNEER IR 501 IMPACT ALUMINUM STOREFRONT

NOTE: SEE ANCHORING DRAWINGS FOR ANCHOR TYPES AND SPACING.

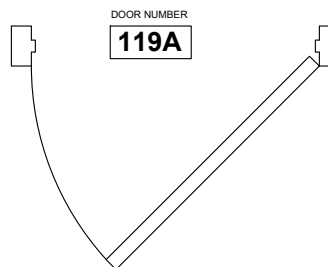

HARDWARE

DOOR(S): 119A (SINGLE)
GROUP #36W

- 2 Continuous Gear Hinge BY DOOR MANUFACTURER
- 1 Panic Hardware VON DUPRIN HH-9947-NL-OP
- 1 Rim Cylinder SCHLAGE 20-057
- 2 90 Degree Offset Pull IVES 8190-O 10"
- 2 Closures LCN-4040 XP PA S CUSN N STOP
- 1 Seal PERIMETER SEAL BY FRAME MANUFACTURER
- 2 Door Sweep ZERO APPROVED FOR USE WITH OPENING SYSTEM
- 1 Threshold ZERO APPROVED FOR USE WITH OPENING SYSTEM

NOTE: VERIFY WINDSTORM CERTIFICATION OF SPECIFIED HARDWARE BUILT AS BASIS-OF-DESIGN AROUND KAWNEER 500 IR DOOR SYSTEM.

EVINS GLASS SERVICE, INC.

101 N.P.I.D., CORPUS CHRISTI, TX 78406

WORK (361) 884-3995 FAX (361) 884-4262

PROJECT: CoastLife, PORTLAND BRANCH
NEW BUILDING
ARCHITECT: MG ARCHITECTS
GENERAL CONTRACTOR: INTEGRATED BUILDERS GROUP

PROJECT NO. EGS-2103-02

DRAWN BY: fp DATE: 10/01/2021

SCALE: 1/2" = 1'-0"

DRAWING: ELEVATIONS

SHEET: E8

NO.	DATE	BY	DESCRIPTION
1	10/01/21	fp	Corrections to First Submittal
1	04/08/21	fp	First Submittal

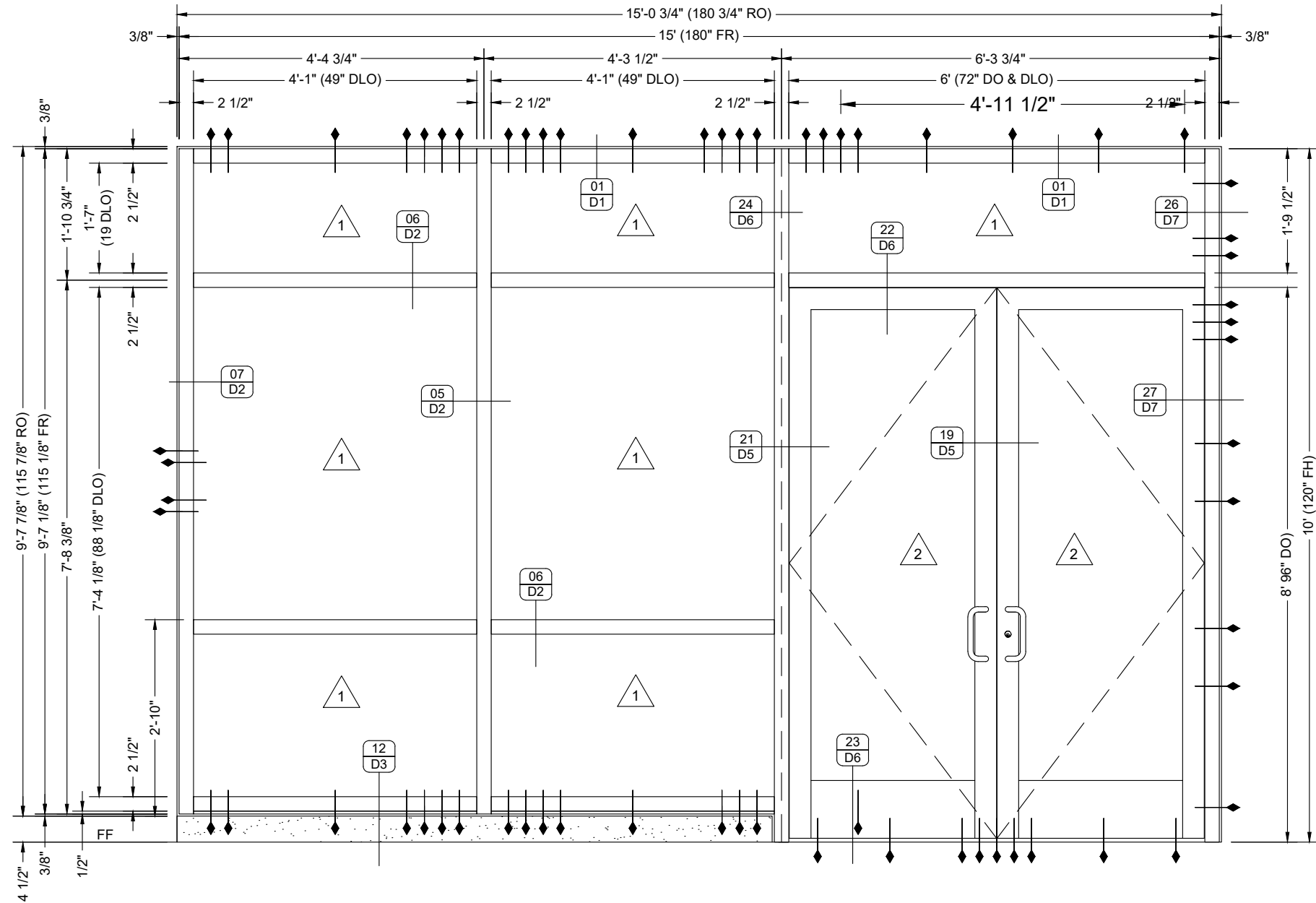

ELEVATION

QUANTITY: 01
 SCALE: 1/2" = 1'-0"
 ARCH REF: A3/A111.1
 A1/A602.1
 DOOR NUMBER(S): 100A1

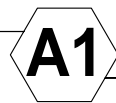

EXT STOREFRONT

KAWNEER IR 501 IMPACT ALUMINUM STOREFRONT

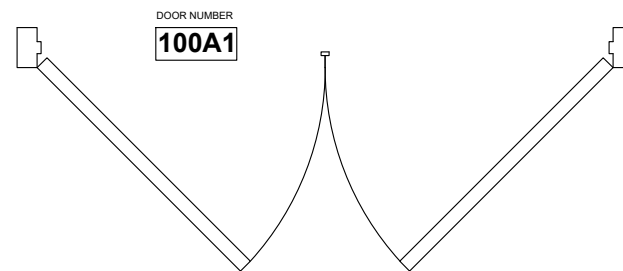

NOTE: SEE ANCHORING DRAWINGS FOR ANCHOR TYPES AND SPACING.

HARDWARE

DOOR(S): 100A1 (PAIR)
 GROUP #34W

- 2 Continuous Gear Hinge BY DOOR MANUFACTURER
- 1 Panic Hardware VON DUPRIN HH-9947-NL-EO-SNB LENGTH & HEIGHT AS REQUIRED
- 1 Panic Hardware VON DUPRIN HH-9947-OP-SNB LENGTH & HEIGHT AS REQUIRED
- 1 Rim Cylinder SCHLAGE 20-057
- 2 90 Degree Offset Pull IVES 8190-O 10"
- 2 Closures LCN-4041 XP PA SCUSH
- 1 Seal PERIMETER SEAL BY FRAME MANUFACTURER
- 1 Astragal MEETING STILE SEAL BY DOOR MANUFACTURER
- 2 Door Sweep ZERO APPROVED FOR USE WITH OPENING SYSTEM
- 1 Threshold ZERO APPROVED FOR USE WITH OPENING SYSTEM

NOTE: VERIFY WINDSTORM CERTIFICATION OF SPECIFIED HARDWARE BUILT AS BASIS-OF-DESIGN AROUND KAWNEER 500 IR DOOR SYSTEM.

NO.	DATE	BY	DESCRIPTION
1	10/01/21	fp	Corrections to First Submittal
1	04/06/21	fp	First Submittal

EVINS GLASS SERVICE, INC.

101 N.P.I.D., CORPUS CHRISTI, TX 78406
 WORK (361) 884-3995 FAX (361) 884-4262

PROJECT: CoastLife PORTLAND BRANCH
NEW BUILDING
 ARCHITECT: MG ARCHITECTS
 GENERAL CONTRACTOR: INTEGRATED BUILDERS GROUP

PROJECT NO.	EGS-2103-02
DRAWN BY	fp
DATE	10/01/2021
SCALE	1/2" = 1'-0"
DRAWING	ELEVATIONS
SHEET	E9

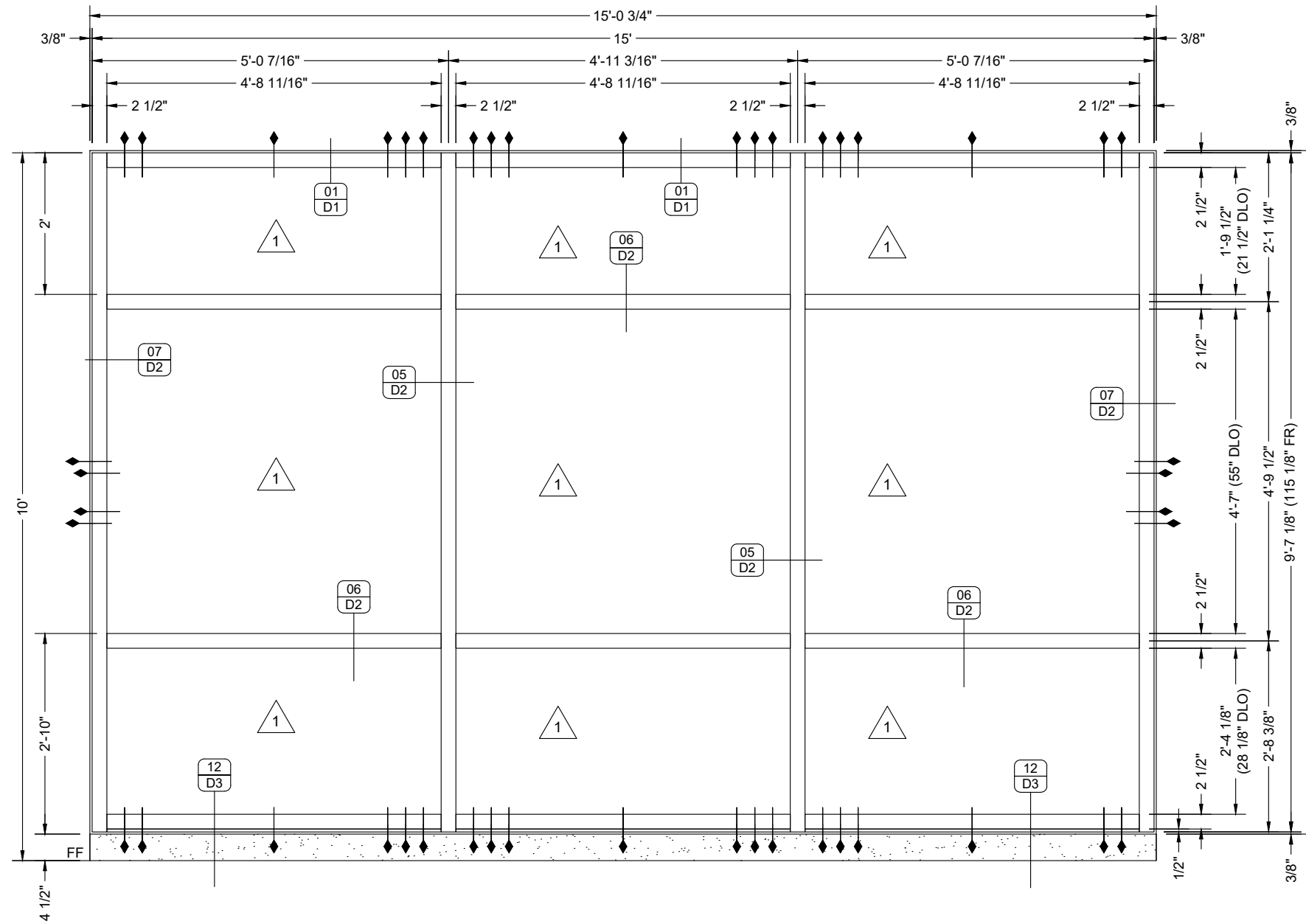

ELEVATION

QUANTITY: 01
 SCALE: 1/2" = 1'-0"
 ARCH REF: A3/A111.1
 A5/A301.1
 B3/A301.1
 C1/A501

B1 EXT STOREFRONT

KAWNEER IR 501 IMPACT ALUMINUM STOREFRONT

NOTE: SEE ANCHORING DRAWINGS FOR ANCHOR TYPES AND SPACING.

EVINS GLASS SERVICE, INC.
 101 N.P.I.D., CORPUS CHRISTI, TX 78406
 WORK (361) 884-3995 FAX (361) 884-4262

PROJECT: CoastLife, PORTLAND BRANCH
NEW BUILDING
 ARCHITECT: MG ARCHITECTS
 713-582-0707
 GENERAL CONTRACTOR: INTEGRATED BUILDERS GROUP
 816-268-4737

PROJECT NO.		EGS-2103-02
DRAWN BY	DATE	fp 10/01/2021
SCALE		1/2" = 1'-0"
DRAWING		ELEVATIONS
SHEET		E10

SUB	BY	DATE	DESCRIPTION
1	fp	10/01/21	Corrections to First Submittal
1	fp	04/06/21	First Submittal

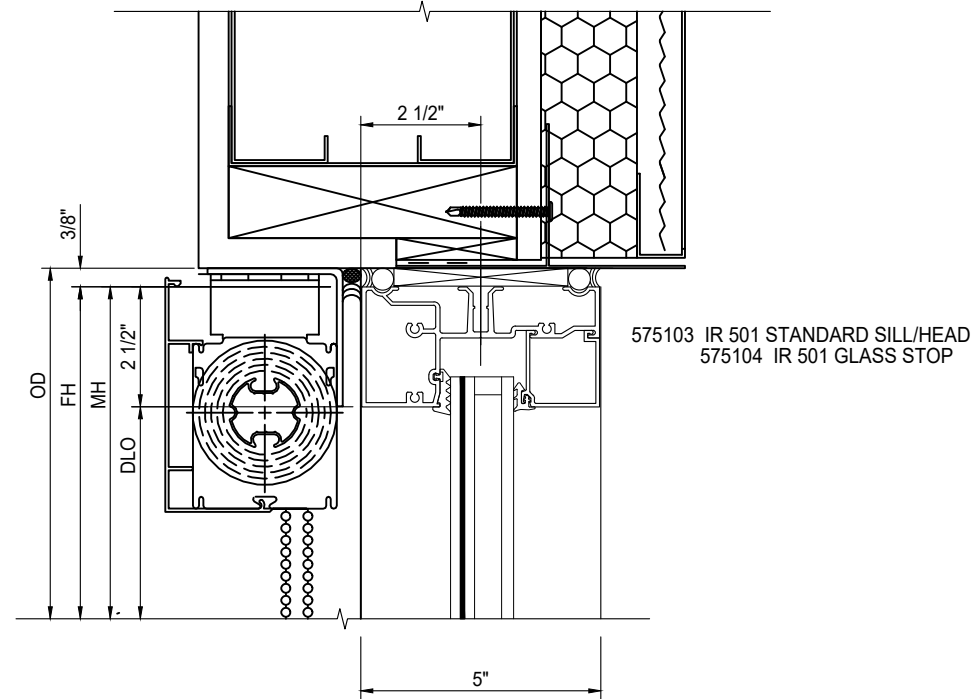

DETAIL

01

HEAD

SCALE: 3" = 1'-0"
 ARCH REF: C1/A501

GLASS WALL SYSTEM TYPE:
 KAWNEER IR 501 IMPACT RESISTANT ALUMINUM STOREFRONT

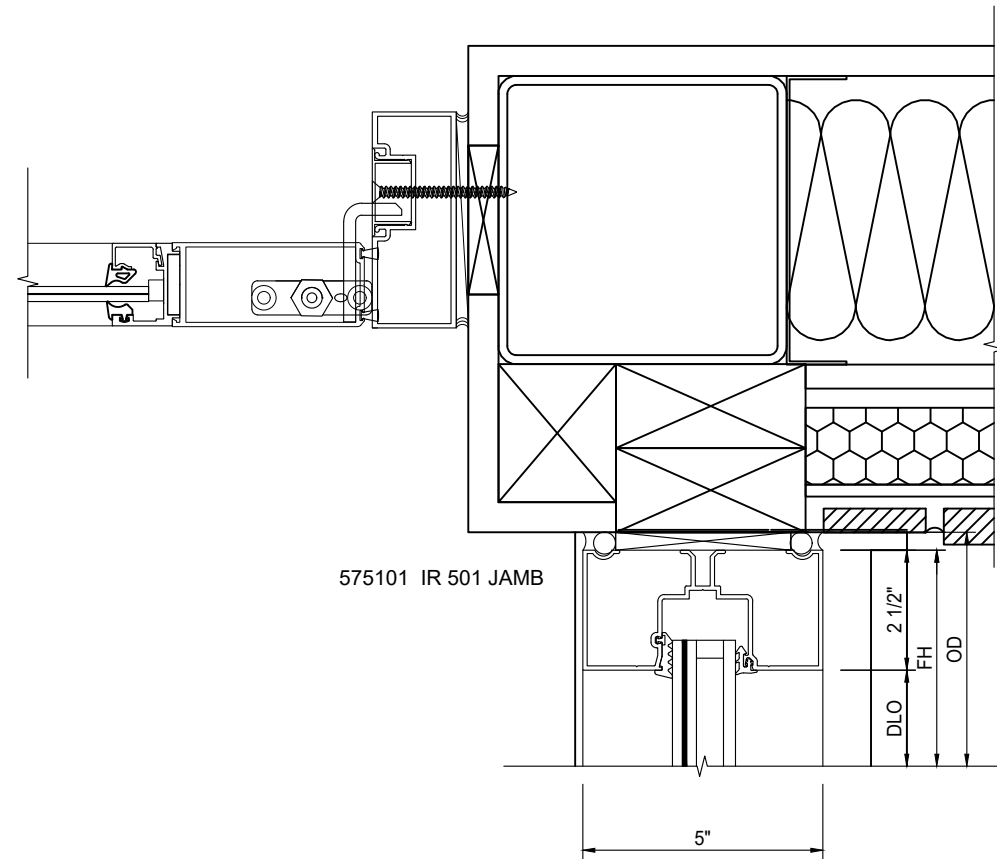

DETAIL

03

MIXED WALL JUNCTION

SCALE: 3" = 1'-0"
 ARCH REF: C6/A501

GLASS WALL SYSTEM TYPE:
 KAWNEER IR 501 IMPACT RESISTANT ALUMINUM STOREFRONT
 ASSA ABLOY SL500 BESAM INTERIOR SLIDING DOOR

NOTE TO ARCHITECT:
 THE SLIDING DOOR AND STOREFRONT WILL NOT SUPPORT EACH OTHER AND WILL REQUIRE A SUPPORT STRUCTURE TO MOUNT ON.

- 575158 IR 501 OPTIONAL SILL
- 575157 FLASHING
- 575208 END DAM
- 575159 IR 501 OPTIONAL SILL COVER
- 575104 IR 501 GLASS STOP

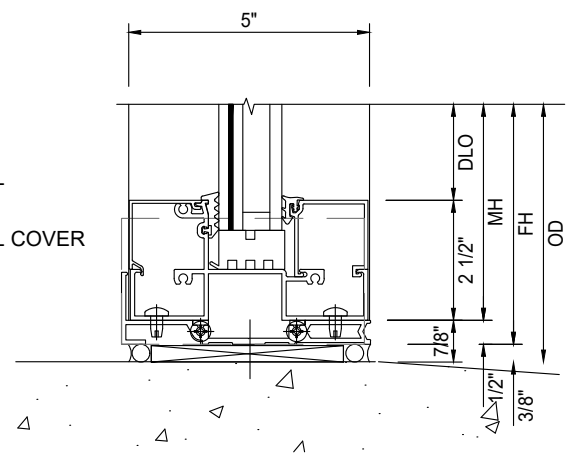

DETAIL

02

SILL

SCALE: 3" = 1'-0"
 ARCH REF: N/A

GLASS WALL SYSTEM TYPE:
 KAWNEER IR 501 IMPACT RESISTANT ALUMINUM STOREFRONT

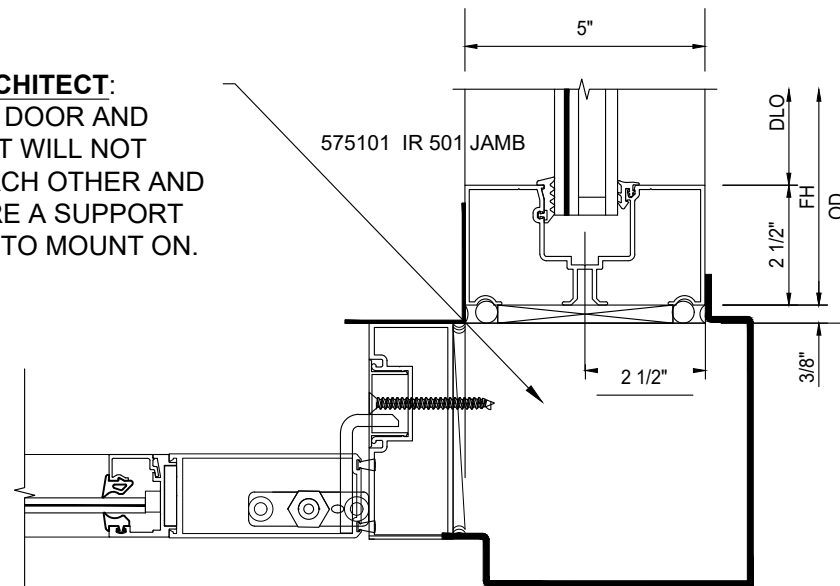

DETAIL

04

MIXED OUTSIDE CORNER

SCALE: 3" = 1'-0"
 ARCH REF: B6/A501

GLASS WALL SYSTEM TYPE:
 KAWNEER IR 501 IMPACT RESISTANT ALUMINUM STOREFRONT
 ASSA ABLOY SL500 RESILIENCE IMPACT RESISTANT SLIDING DOOR

EVINS GLASS SERVICE, INC.
 101 N.P.I.D., CORPUS CHRISTI, TX 78406
 WORK (361) 884-3995 FAX (361) 884-4262

PROJECT: CoastLife, PORTLAND BRANCH
NEW BUILDING
 ARCHITECT: MG ARCHITECTS
 713-582-0707
 GENERAL CONTRACTOR: INTEGRATED BUILDERS GROUP
 916-268-4737

PROJECT NO.		EGS-2103-02
DRAWN BY	DATE	fp 10/01/2021
SCALE		3" = 1'-0"
DRAWING		DETAILS
SHEET		D1

NO.	DATE	DESCRIPTION
1	10/01/21	fp
1	04/06/21	fp
1		Sub
1		By
1		DATE
1		DESCRIPTION
1		Corrections to First Submittal
1		First Submittal